



JABO SUPPLY CORPORATION

DOMESTIC

CARBON STEEL



O'LETS

JABO SUPPLY



5 LOCATIONS

PARKERSBURG, WV

10085 Emerson Avenue 26102
(304) 464-4400

MORGANFIELD, KY

118 Jim Veatch Road, 42437
(270) 389-3430

HUNTINGTON WV

209 Braley Street, 25705
(304) 736-8333

NORTON, VA

205 Hawthorne Drive, 24273
(276) 679-1224

BEAVER, WV (BECKLEY)

227 C&O Shop Road 25813
(304-252-0000





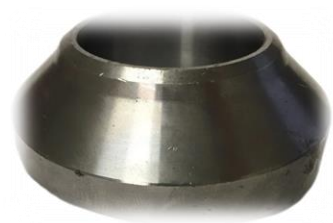

SINCE 1964 SERVICE IS MORE THAN A PROMISE

INDEX

	PAGE #
Picture Index O'lets (Domestic Sourced)	4
Weldolets (STD)	5
Weldolets (XH)	5
Socketolets	6
Elbolets	6
Threadolets	6
Outlets and Pipe Size Available	7
Specifications	8-9



PIC INDEX DOMESTIC CARBON STEEL O'LETS FORGED FITTINGS

WELD O'LET	WELD O'LET	SOCKOLET	ELBOLET
STANDARD	XH	3000	3000
			
PAGE 5	PAGE 5	PAGE 6	PAGE 6
THREAD OLET	SIZE CHART	SPECIFICATIONS	
3000	3000	3000	
	<i>SIZE CHART</i>	<i>SPECIFICATIONS</i>	
PAGE 6	PAGE 7	PAGE 9-10	CALL JABO SUPPLY

DOMESTIC FORGED O'LETS

WELDOLET (STD/XH)

WELDOLET STD CARBON STEEL



JABO #	PIPE SIZE	OUTLET SIZE
008-00400	36-1 - 1/4	X 1/2"
008-00440	36-2 - 1/2"	X 3/4"
008-00700	36 - 3"	X 1"
008-00760	6 - 2-1/2"	X 1-1/4"
008-00980	3-1/2 - 2"	X 1-1/2"
008-01140	3 - 2-1/2"	X 2"
008-01220	6 - 3-1/2"	X 2"
008-01240	36 - 8"	X 2"
008-01320	5 - 4"	X 2-1/2"
008-01360	8 - 6"	X 2-1/2"
008-01540	4 - 3-1/2"	X 3"
008-01580	6 - 5"	X 3"
008-01920	6 - 5"	X 4"
008-02310	10 - 8"	X 4"
008-02320	8	X 6"
008-02390	14 - 12"	X 6"

WELDOLET XH CARBON STEEL



JABO #	PIPE SIZE	OUTLET
008-03100	36-1	X 1/2"
008-03180	36-2	X 3/4"
008-03340	36-3 1/2	X 1"

HOW TO READ

EXAMPLE

36-1-1/4 X 1/2

1st number 36-Max Pipe OD

2nd number 1-1/4- Smallest Pipe OD

3rd number X 1/2- Outlet Size

DOMESTIC FORGED O'LETS**SOCKOLET / ELBOOLET / THREDOLET****SOCKOLET #3000 FORGED STEEL**

JABO #	PIPE SIZE	OUTLET SIZE
008-06600	36 - 3/4"	X 1/2"
008-06620	36 - 1-1/2"	X 3/4"
008-06740	36 - 3"	X 1"
008-07000	2-1/2 - 2"	X 1-1/2"
008-07040	5 - 3"	X 1-1/2"
008-08000	6 - 4"	X 2"

HOW TO READ**EXAMPLE**

36-3/4 X 1/2

1st number 36-Max pipe OD

2nd number 3/4"- Smallest pipe OD

3rd number X 1/2- Outlet size

ELBOLET #3000 FORGED STEEL

JABO #	PIPE SIZE	OUTLET SIZE
008-05060	36-1	X 3/4"
Other Sizes avail upon request		

THREDOLET #3000 FORGED STEEL

JABO #	PIPE SIZE	OUTLET SIZE
008-10660	36 - 1/2"	X 1/4"
008-10810	36 - 1-1/4"	X 3/8"
008-10900	36 - 3/4"	X 1/2"
008-11060	36 - 1-1/2"	X 3/4"
008-11180	2-1/2 - 1-1/4"	X 1"
008-11240	36 - 3"	X 1"
008-11400	3-1/2 - 2"	X 1-1/4"
008-11420	36 - 4"	X 1-1/4"
008-11500	2-1/2 - 2"	X 1-1/2"
008-11540	5 - 3"	X 1-1/2"
008-11580	36 - 6"	X 1-1/2"
008-11700	3-1/2 - 2-1/2"	X 2"
008-11740	6 - 4"	X 2"
008-11800	36 - 8"	X 2"
008-12000	5 - 4"	X 2-1/2"
008-12080	4 - 3-1/2"	X 3"
008-12100	6 - 5"	X 3"

FOR ADDITIONAL SIZES SEE THE
FOLLOWING PAGE

OUTLET AND PIPE SIZES AVAILABLE

PIPE RUN SIZES	BUTT-WELD (STD)											
	OUTLET SIZE - INCHES											
	1/4"	3/8"	1/2"	3/4"	1"	1 1/4"	1 1/2"	2"	2 1/2"	3"	4"	6"
	36 - 3/8"	36 - 3/4"	36 - 1 1/4"	36 - 2 1/2"	36 - 2"	36 - 8"	36 - 4"	36 - 8"	36 - 12"	36 - 16"	36 - 22"	42 - 36"
	1/4"	1/2 - 3/8"	1 - 1/2"	2 - 3/4"	3 1/2" - 1 1/4"	6 - 2 1/2"	3 1/2" - 2"	6 - 3 1/2"	10 - 5"	14 - 8"	20 - 12"	34 - 26"
					1"	2 - 1 1/2"	1 1/2"	3 - 2 1/2"	4 - 3"	6 - 5"	10 - 8"	24 - 20"
						1 1/4"		2"	2 1/2"	4 - 3 1/2"	6 - 5"	18 - 16"
										3"	4"	14 - 12"
												10"
												8"
												6"
PIPE RUN SIZES	BUTT-WELD (EXTRA STRONG)											
	OUTLET SIZE - INCHES											
	1/4"	3/8"	1/2"	3/4"	1"	1 1/4"	1 1/2"	2"	2 1/2"	3"	4"	6"
	36 - 1/4"	36 - 1 1/2"	36 - 1"	36 - 2"	36 - 2"	36 - 6"	36 - 4"	36 - 8"	36 - 12"	36 - 16"	36 - 22"	42 - 36"
		3/8"	3/4" - 1/2"	1 1/2" - 3/4"	3" - 1 1/4"	5 - 2 1/2"	3 1/2" - 2"	6 - 3 1/2"	10 - 5"	14 - 8"	20 - 12"	34 - 26"
					1"	2 - 1 1/4"	1 1/2"	3 - 2 1/2"	4 - 3"	6 - 5"	10 - 8"	24 - 20"
								2"	2 1/2"	4 - 3 1/2"	6 - 5"	18 - 16"
										3"	4"	14 - 12"
												10"
												8"
												6"
PIPE RUN SIZES	SOCKET-WELD (3000#)											
	OUTLET SIZE - INCHES											
	1/4"	3/8"	1/2"	3/4"	1"	1 1/4"	1 1/2"	2"	2 1/2"	3"	4"	
	36 - 3/8"	36 - 3/4"	36 - 3/4"	36 - 1 1/2"	36 - 3"	36 - 4"	36 - 6"	36 - 8"	36 - 10"	36 - 16"	36 - 22"	
	1/4"	1/2 - 3/8"	1/2"	1 1/4 - 3/4"	2 1/2" - 1 1/4"	3 1/2" - 2"	5 - 3"	6 - 4"	8 - 6"	14 - 8"	20 - 12"	
					1"	1 1/2" - 1 1/4"	2 1/2" - 2"	3 1/2" - 2 1/2"	5 - 4"	6 - 5"	10 - 8"	
							1 1/2"	2"	3 1/2" - 3"	4 - 3 1/2"	6 - 5"	
									2 1/2"	3"	4"	
PIPE RUN SIZES	SOCKET-WELD (6000#)											
	OUTLET SIZE - INCHES											
	1/4"	3/8"	1/2"	3/4"	1"	1 1/4"	1 1/2"	2"	2 1/2"	3"	4"	
	36 - 1/4"	36 - 3/8"	36 - 3/4"	36 - 1 1/4"	36 - 3"	36 - 5"	36 - 6"	36 - 8"	36 - 20"	36 - 28"	36 - 16"	
			1/2"	1 - 3/4"	2 1/2" - 1 1/4"	4 - 1 1/2"	5 - 3"	6 - 4"	18 - 6"	26 - 12"	14 - 10"	
					1"	1 1/4"	2 1/2" - 2"	3 1/2" - 2 1/2"	5 - 3 1/2"	10 - 6"	8 - 6"	
							1 1/2"	2"	3 - 2 1/2"	5 - 4"	5"	
										3 1/2" - 3"	4"	
PIPE RUN SIZES	THREADED (3000#)											
	OUTLET SIZE - INCHES											
	1/4"	3/8"	1/2"	3/4"	1"	1 1/4"	1 1/2"	2"	2 1/2"	3"	4"	
	36 - 1/2"	36 - 1 1/4"	36 - 3/4"	36 - 1 1/2"	36 - 3"	36 - 4"	36 - 6"	36 - 8"	36 - 10"	36 - 16"	36 - 22"	
	3/8 - 1/4"	1 - 3/8"	1/2"	1 1/4 - 3/4"	2 1/2" - 1 1/4"	3 1/2" - 2"	5 - 3"	6 - 4"	8 - 6"	14 - 8"	20 - 12"	
					1"	1 1/2" - 1 1/4"	2 1/2" - 2"	3 1/2" - 2 1/2"	5 - 4"	6 - 5"	10 - 8"	
							1 1/2"	2"	3 1/2" - 3"	4 - 3 1/2"	6 - 5"	
									2 1/2"	3"	4"	
PIPE RUN SIZES	THREADED (6000#)											
	OUTLET SIZE - INCHES											
	1/4"	3/8"	1/2"	3/4"	1"	1 1/4"	1 1/2"	2"	2 1/2"	3"	4"	
	36 - 1/2"	36 - 1 1/4"	36 - 3/4"	36 - 1 1/2"	36 - 3"	36 - 10"	36 - 6"	36 - 8"	36 - 28"	36 - 14"	36 - 20"	
	3/8 - 1/4"	1 - 3/8"	1/2"	2 1/2" - 1"	2 1/2" - 1 1/4"	8 - 4"	5 - 3"	6 - 4"	26 - 12"	12 - 8"	18 - 12"	
				3/4"	1 1/4 - 1"	3 1/2" - 2"	2 1/2" - 2"	3 1/2" - 2 1/2"	10 - 6"	6 - 5"	10 - 8"	
						1 1/2" - 1 1/4"	1 1/2"	2"	5 - 4"	4"	6"	
									3 1/2" - 3"	3 1/2"	5"	
									2 1/2"	3"	4"	

FLAT SIZE available 1/8" through 6" pipe outlet. Traditional line of run pipe size available on inquiry.

Size on Size are conventional funneled inlet design

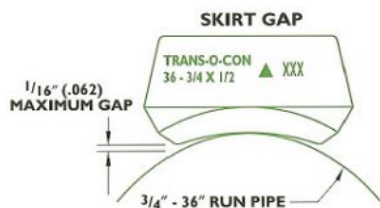

HOW CONDENSED SIZE WORKS:
Each forged outlet size listed on the chart is designed to fit a range of pipe run sizes.
For example: The 1/2" fitting marked 36 - 3/4" will fit each pipe run size from 3/4" to 36". There will be a maximum 1/16" gap as illustrated in diagrams. This gap is negligible when welding and has no adverse effect on the integrity of the connection.
MINIMIZE WARHOUSE INVENTORY

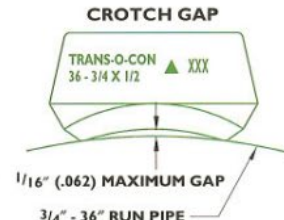

O'LETS

SPECIFICATIONS



TRANS-O-CON® Butt-Weld Reducing Sizes

MSS SP-97

OUTLET SIZE (INCHES)	DIMENSIONS				APPROX. WEIGHT POUNDS	
	STANDARD		EXTRA STRONG		STANDARD	EXTRA STRONG
	A	C	A	C		
1/4"	.652	.364	.625	.302	.08	.10
3/8"	.750	.493	.750	.423	.09	.15
1/2"	.750	.622	.750	.546	.35	.40
3/4"	.875	.824	.875	.742	.40	.45
1"	1.063	1.049	1.063	.957	.50	.60
1 1/4"	1.250	1.380	1.250	1.278	.70	.80
1 1/2"	1.313	1.610	1.313	1.500	.75	.85
2"	1.500	2.067	1.500	1.939	1.29	1.35
2 1/2"	1.625	2.469	1.625	2.323	1.75	1.82
3"	1.750	3.068	1.750	2.900	2.63	2.75
4"	3.000	4.026	2.000	3.826	4.30	4.45
5"	2.125	5.047	2.125	4.813	9.59	6.39
6"	2.375	6.065	2.375	5.761	12.00	17.60
8"	2.750	7.981	3.875	7.625	23.00	34.80
10"	3.06	10.02	3.69	9.750	27.22	36.19
12"	3.38	12.00	4.06	11.750	34.00	67.00
14"	3.50	13.25	3.94	13.000	56.00	72.25
16"	3.69	15.25	4.18	15.000	76.00	102.10
18"	3.81	17.25	4.38	17.000	97.00	129.75
20"	4.00	19.25	4.69	19.000	120.00	166.00
24"	4.56	23.25	5.50	23.000	194.61	267.00



STRAIGHT
THRU
BORE

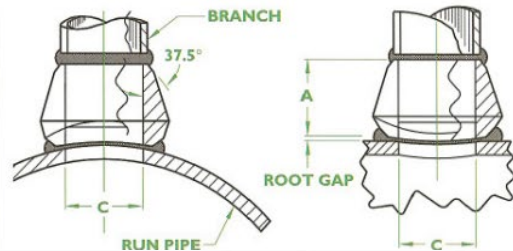

TRANS-O-CON® Threaded Reducing Sizes

MSS SP-97



OUTLET SIZE (INCHES)	DIMENSIONS						APPROX. WEIGHT POUNDS	
	3000 #			6000 #			3000 #	6000 #
	A	C	F	A	C	F		
1/8"	.750	.328	.875				.10	
1/4"	.750	.437	.875				.10	
3/8"	.813	.562	1.000				.16	
1/2"	1.000	.703	1.250	1.250	.703	1.563	.25	.40
3/4"	1.063	.906	1.438	1.438	.906	1.813	.38	.70
1"	1.313	1.141	1.813	1.563	1.141	2.250	.70	1.20
1 1/4"	1.359	1.469	2.188		1.469		.90	1.50
1 1/2"	1.375	1.719	2.436	1.688	1.719	3.000	1.40	1.90
2"	1.531	2.188	2.938	2.063	2.188	3.625	1.80	5.00
2 1/2"	1.813	2.528	3.438				3.00	
3"	2.000	3.203	4.125				4.35	
4"	2.250	4.203	5.125				7.10	

NOTE: NPT Threads
to B1.20.1.

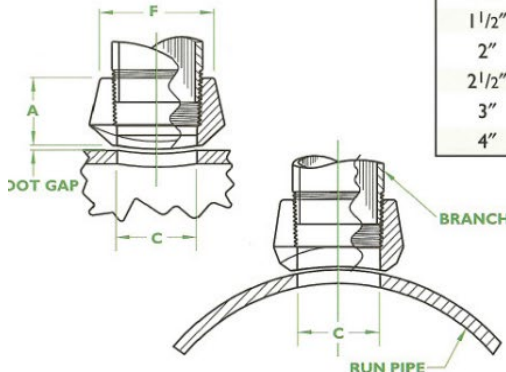

NEW FORGING
TECHNOLOGY

O'LETS

SPECIFICATIONS



TRANS-O-CON® Socket Reducing Sizes

MSS SP-97

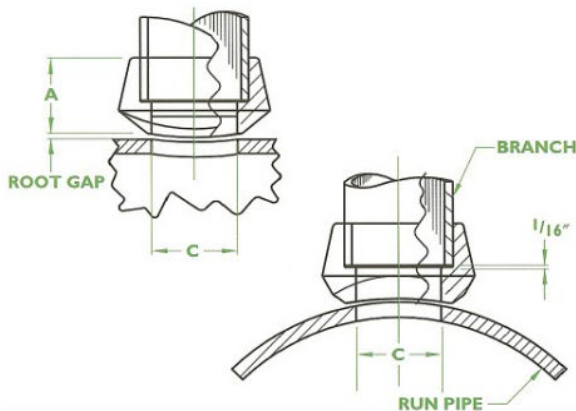

OUTLET SIZE (INCHES)	DIMENSIONS				APPROX. WEIGHT POUNDS	
	3000 #		6000 #		3000 #	6000 #
	A	C	A	C		
1/8"	.750	.364			.10	
1/4"	.750	.364			.10	
3/8"	.813	.493			.16	
1/2"	1.000	.622	1.250	.464	.25	.45
3/4"	1.063	.824	1.438	.612	.38	.70
1"	1.313	1.049	1.563	.8153	.70	1.10
1 1/4"	1.359	1.380	1.625	1.160	.90	1.50
1 1/2"	1.375	1.610	1.668	1.338	1.40	1.80
2"	1.531	2.067	2.063	1.687	1.80	4.70
2 1/2"	1.563	2.469			2.75	
3"	1.750	3.068			3.80	
4"	1.875	4.026			7.25	

NOTE: Socket minimum depth per ANSI B16.11.

TRANS-O-CON® Elbow & Lateral Connections

3000# for 90° long radius pipe elbows

Butt Weld / Socket / Threaded

ELBOW SIZES (INCHES)	OUTLET SIZE (INCHES)	DIMENSIONS		APPROX. WEIGHT POUNDS
		C	E	
36 - 3/4"	1/2" *	1.500	1.594	.50
36 - 1"	3/4" *	1.813	1.875	.70
36 - 2"	1" *	2.250	2.188	1.15
36 - 2"	1 1/2"	3.125	2.625	2.65
36 - 3"	2"	4.188	3.185	5.25

45° LATERAL

OUTLET SIZE (INCHES)	1/2" *	3/4" *	1" *	1 1/4"	1 1/2"	2"
SIZE RANGE (INCHES)	12 - 3 2 1/2 - 1 1/4	12 - 6 5 - 3 2 1/2 - 2	12 - 6 5 - 3 2 1/2 - 2	12 - 6 5 - 3 2 1/2 - 2	12 - 10 8 - 6 5 - 4	12 - 10 8 - 6 5 - 4

* Available in 6000#

THREADED
LATERAL
CONNECTION

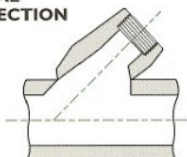

SOCKET
LATERAL
CONNECTION

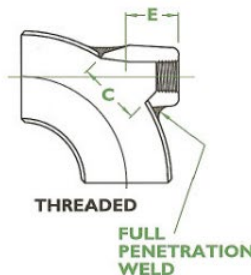
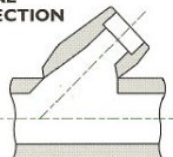

THREADED

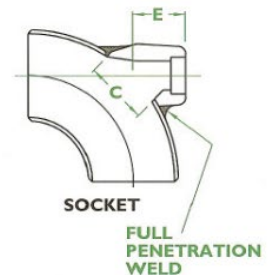
FULL
PENETRATION
WELD

SOCKET

FULL
PENETRATION
WELD

NOTE: Butt-Welding end dimensions to ANSI B16.9 and ANSI B 16.25.

CARBON STEEL O'LETS



JABO SUPPLY SINCE 1964 SERVICE IS MORE THAN A PROMISE
(304)-736-8333